

FLOW TEST RESULTS:
 CONDUCTED BY JEA ON 11/30/17 AT 10:46 AM
 FLOW HYDRANT LOCATION: KIPP AV & LOUISA ST (8304)
 STATIC RESIDUAL HYDRANT LOCATION: KIPP AV & HOME ST (2161)
 NUMBER OF PORTS: 2
 DIAMETER OF PORTS (INCHES): 2.5
 PITOT PRESSURE (PSI): 24
 STATIC PRESSURE (PSI): 76
 RESIDUAL PRESSURE (PSI): 57
 FLOW AT TEST: 1,653 GPM
 FLOW AT 20 PSI: 2,964 GPM

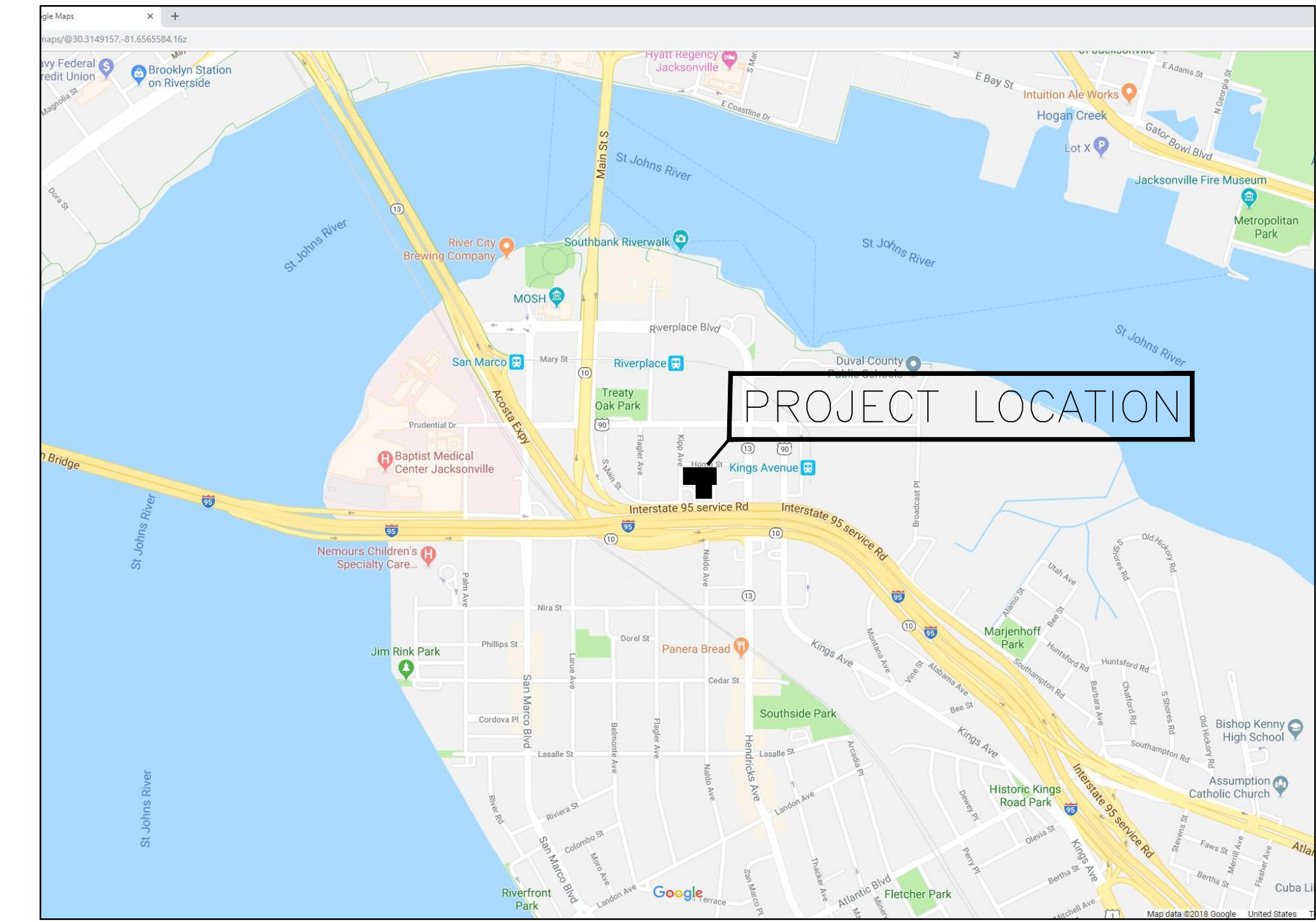

NICET Level IV Automatic Sprinkler
 System Layout Certification #79357
 Richard P. Koster

1444 HOME STREET
 Jacksonville, Florida

SITE PLAN / GENERAL NOTES / DETAILS

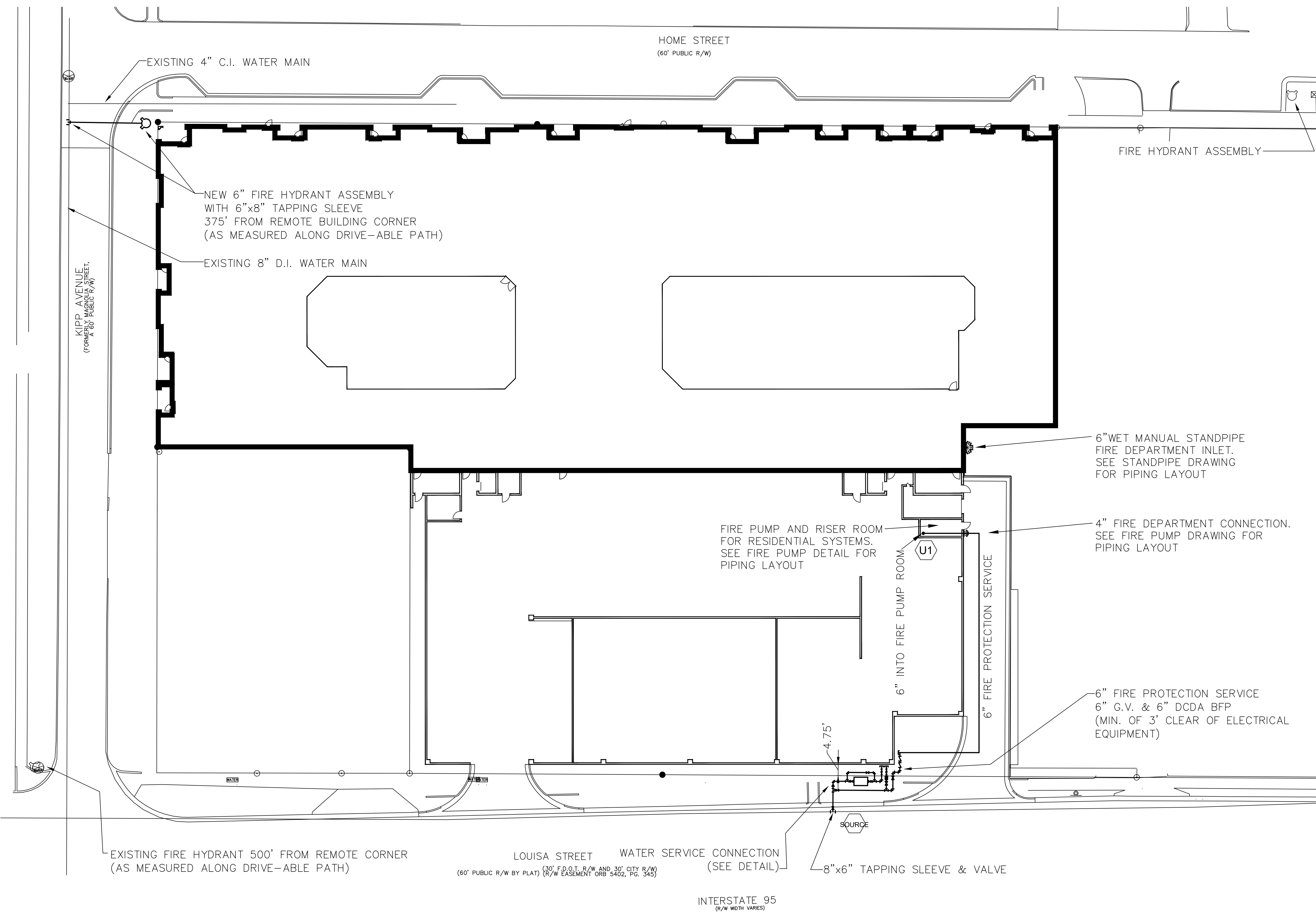

GENERAL NOTES

SCOPE OF WORK

- NEW 4-STORY RESIDENTIAL FACILITY PROTECTED THROUGHOUT WITH WET-PIPE SPRINKLER SYSTEM
 - APARTMENT BUILDING - WET SYSTEM TO BE INSTALLED THROUGHOUT LEVELS 1-4
 - INTERSTITIAL & ATTIC SPACES FILLED ENTIRELY WITH INSULATION - "COIN" SPRINKLERS NOT REQUIRED
 - PIPING IN INTERSTITIAL & ATTIC SPACES - FITTED WITH RESIDENTIAL PENDENT SPRINKLERS
 - WET MANUAL STANDPIPE SYSTEM TO BE INSTALLED AS FOLLOWS:
 - BUILDING - IN STAIRS #1 AND #2, AND (3) IN CORRIDORS FOR FLOORS 1-4
 - PARKING GARAGE - NOT IN CONTRACT
 - DESIGN PER NFPA #13 AND #14 2013 EDITIONS FOR THE FOLLOWING OCCUPANCIES:
 - RESIDENTIAL FLOORS - NFPA #13, SECTION 11.3.1
 - 1ST FLOOR CLUB HOUSE - NFPA #13, SECTION A.5.2 LIGHT HAZARD
 - SPRINKLER HEADS TO BE LOCATED IN THE CENTER OF OR QUARTER POINTS CEILING TILES - SEE FP DRAWINGS FOR LOCATIONS
 - HANGER MATERIALS / SPRINKLING MEETING N.F.P.A. #13 - 1 OR 2-HOLE STRAPS
 - SEISMIC BRACE HANGERS - NOT REQUIRED
 - WATER FLOW SWITCH / TAMPER SWITCH / ELECTRIC BELLS WILL BE INSTALLED - WIRING BY FIRE ALARM CONTRACTOR
 - UNDERGROUND WATER MAINS - NOT IN CONTRACT (INSTALLED BY OTHERS)

OCCUPANCY / DESIGN CRITERIA / SPECIAL COMPONENTS

- LIGHT HAZARD / ORDINARY HAZARD GROUP 1 / WET MANUAL STANDPIPE DESIGN
- SPRINKLERS TO BE USED:
 - BRASS - 5.8K QUICK RESPONSE (QR) STANDARD COVERAGE UPRIGHT (MISC. AREAS)
 - BRASS - 5.8K QUICK RESPONSE (QR) EXTENDED COVERAGE "COIN" UPRIGHT FOR INTERSTITIAL/ATTIC SPACES
 - WHITE - 5.8K QUICK RESPONSE (QR) EXTENDED COVERAGE RESIDENTIAL RECESSED PENDENT (UNITS AND CORRIDORS)
 - WHITE - 5.8K QUICK RESPONSE (QR) STANDARD COVERAGE RECESSED PENDENT (MISC. AREAS)
 - WHITE - 5.8K QUICK RESPONSE (QR) EXTENDED COVERAGE RECESSED DRY SIDEWALL (UNIT BALCONIES)
 - SPRINKLER SQUARE FOOTAGE:
 - INTERSTITIAL SPACES - 256 SQ.FT. MAX. PER SPRINKLER (LIGHT HAZARD)
 - RESIDENTIAL AND CLUB HOUSE AREAS - PER SPRINKLER HEAD LISTING FOR EXTENDED COVERAGE
 - LIGHT HAZARD DESIGN:
 - WET SYSTEM (RESIDENTIAL AREAS) - 0.10 GPM/SQ.FT. FOR (4) SPRINKLERS + 100 GPM HOSE
 - WET SYSTEM (CLUB HOUSE AREA) - 0.10 GPM/SQ.FT. OVER 1,500 SQ.FT. + 100 GPM HOSE
 - WET SYSTEM (INTERSTITIAL & ATTIC AREAS) - 0.10 GPM/SQ.FT. OVER 1,000 SQ.FT. + 100 GPM HOSE
 - ORDINARY HAZARD DESIGN:
 - MECHANICAL / ELECTRICAL ROOMS - 0.15 GPM/SQ.FT. OVER ENTIRE ROOM + 250 GPM HOSE
 - ALLOWABLE TO UTILIZE DESIGN AREA REDUCTION PER N.F.P.A. #13 FIGURE 11.2.3.2.3.1 FOR LIGHT AND ORDINARY OCCUPANCIES
 - WET MANUAL STANDPIPE DESIGN:
 - 1,000 GPM MAXIMUM REQUIRED FOR ALL STANDPIPES
 - 2 1/2" FIRE HOSE VALVES TO BE INSTALLED ON EACH FLOOR LEVEL
 - STANDPIPES TO BE INTERCONNECTED WITH 6" / 4" MAINS
 - FIRE DEPARTMENT CONNECTION TO BE LOCATED ON THE FACE OF BUILDING - SEE 1ST FLOOR PLAN FOR LOCATION
 - 4" VERTICAL STANDPIPES TO TERMINATE @ ROOF HYDRANTS - SEE STANDPIPE PLAN FOR LOCATIONS AND DETAILS

INSTALLATION METHODS:

ALL MATERIALS / INSTALLATION METHODS WILL COMPLY WITH NFPA #13, 2016 EDITION AND MANUFACTURED FOR 175 PSI WORKING PRESSURE. SYSTEM PIPING TO BE TESTED @ 200-PSI FOR 2 HOURS
 SYSTEM CROSSMAIN PIPING - BLACK STEEL PIPE, UTILIZING GROOVED COUPLINGS AND FITTINGS
 WET SYSTEM BRANCHLINES - BLACK STEEL PIPE, UTILIZING GROOVED FITTINGS & COUPLINGS / OR THREADED FITTINGS
 WET SYSTEM RETURN - CPVC PIPING & FITTINGS
 SPRINKLER HEAD RETURN BENDS TO UTILIZE 1" PIPE & THREADED FITTINGS AND / OR FLEXIBLE DROPS - SEE DETAIL ON FP DRAWINGS

MATERIALS:

- PIPE: WET SYSTEM CROSS-MAINS 2-1/2" & LARGER = BLACK STEEL SCHEDULE #10
 WET SYSTEM PIPING IN RESIDENTIAL AREA AND CLUB HOUSE AREAS = CPVC
 300 LB. DUCTILE IRON FLEXIBLE COUPLINGS / 300 LB. DUCTILE IRON FITTINGS
 THREADED FITTINGS: 125 LB. CAST OR DUCTILE IRON
 BLAZEMASTER PIPING AND FITTINGS (OR EQUIVALENT)
 HANGERS: 1-2 HOLE STRAPS, WOOD SCREWS, ALL THREAD ROD AND HANGER RING COMPONENTS - SPACING PER NFPA #13
 BACKFLOW PREVENTER: DOUBLE CHECK DETECTOR BACKFLOW PREVENTER (EXTERIOR TO BUILDING - BY OTHERS)
 FIRE PUMP: ELECTRIC IN-LINE RATED 400-GPM @ 75-PSI
 JOCKEY PUMP: ELECTRIC MULTI-STAGE RATED 5-GPM @ 100-PSI
 CONTROL VALVES: BUTTERFLY VALVES OR OS7Y GATE VALVES W/ TAMPER SWITCHES
 WET RISER VALVE: VICTAULIC #717R RISER CHECK W/ TRIM
 ALARM DEVICES: WATER FLOW SWITCH / TAMPER SWITCH / 120-V ELECTRIC BELLS WITH WEATHERPROOF BOX
 FDC & ROOF HYDRANT: MEET LOCAL FIRE DEPARTMENT REQUIREMENTS

WATER SUPPLY:

8" CITY MAIN ADJACENT TO FACILITY ENTRANCE IN RIVERSIDE AVE.
 6" LEAD-IN BROUGHT BUILDING 1000 TO BACKFLOW PREVENTER & FIRE PUMP
 6" FROM FIRE PUMP INTO BUILDING 1000 - ENTERS THE BUILDING IN RISER ROOM
 ALL UNDERGROUND WATER MAINS & INSTALLATION BY OTHERS
 FIRE DEPARTMENT CONNECTIONS TO BE LOCATED ON THE FACE OF FIRE PUMP AND RISER ROOMS

WATER FLOW DATA:
 STATIC - 76 PSI
 RESIDUAL - 54 PSI
 GPM FLOW - 1,653 GPM
 TEST DATE - 11/30/17 @ 10:46 AM
 LOCATION - ON 8" CITY MAIN IN LOUISA ST. DIRECTLY ADJACENT TO SITE ENTRANCE AND KIPP AVE.

2220 COUNTY RD. 210 WEST
 SUITE 300-108-139
 JACKSONVILLE, FL 32216
 PH: 904-459-5207

NO.	DATE	BY	DESCRIPTION
1	11/27/18	RP	GENERAL NOTES

NO.	DATE	BY	DESCRIPTION
1	11/27/18	RP	GENERAL NOTES

SCALE: 1/8" = 1'-0"
 JOB NUMBER: 698
 DATE: 10/30/2018